

FUTEK MODEL LBB300 (L1510)

ROUND SHAFT BEAM LOAD CELL

Drawing Number: FI1050

INCH [mm] | R.O.= Rated Output

WIRING CODE (WC1)

+Excitation	-Excitation	+Signal	-Signal
RED	BLACK	GREEN	WHITE

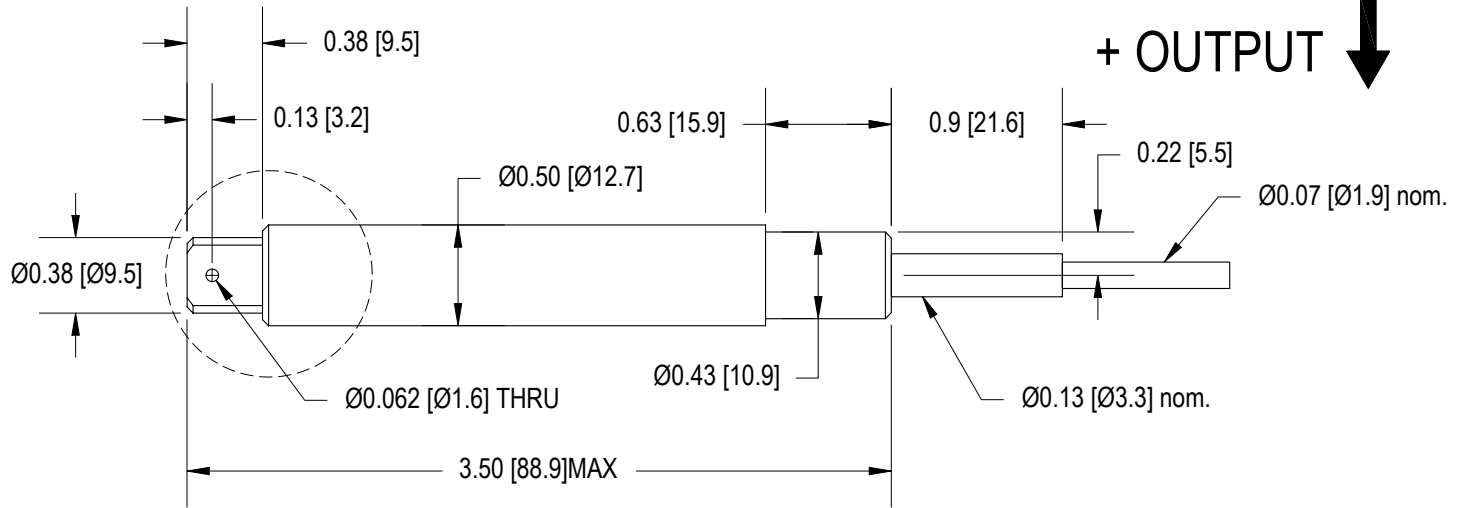
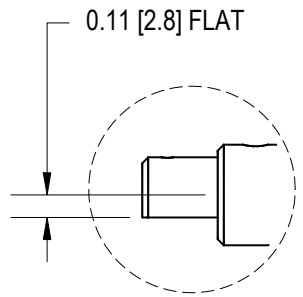
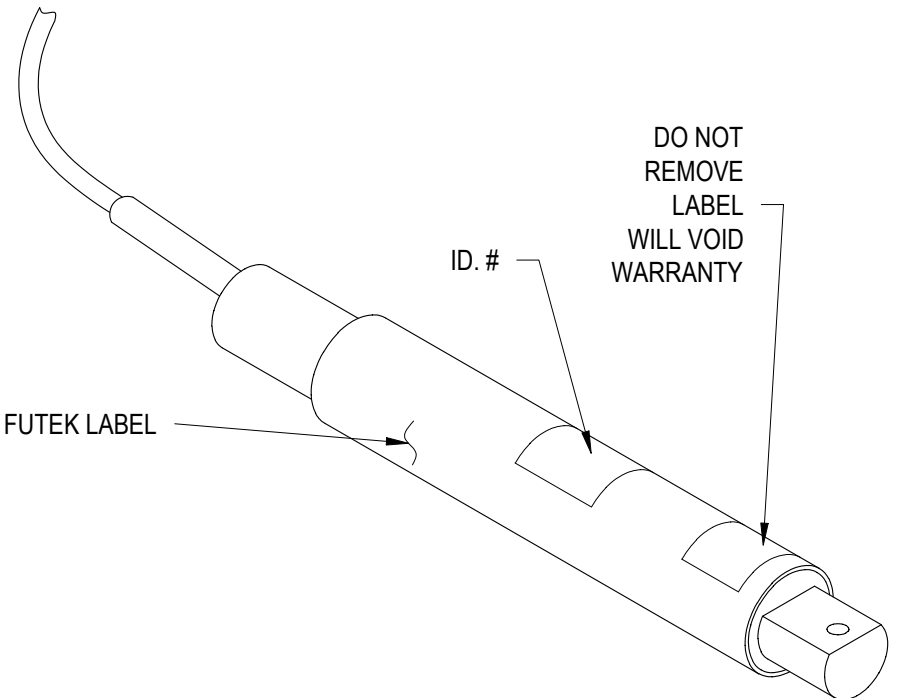

SPECIFICATIONS:

- RATED OUTPUT** 2 mV/V nom.
- SAFE OVERLOAD** 400% (0.25 to 5 lb)
200% (10 lb)
- ZERO BALANCE** ±3% of R.O.
- EXCITATION (VDC OR VAC)** 7 MAX (0.25 to 5 lb) 18 MAX (10 lb)
- BRIDGE RESISTANCE** 350 Ω nom.
- NONLINEARITY** ±0.05% of R.O.
- HYSTERESIS** ±0.05% of R.O.
- NONREPEATABILITY** ±0.03% of R.O.
- TEMP. SHIFT ZERO** ±0.005% of R.O./°F [0.01% of R.O./°C]
- TEMP. SHIFT SPAN** ±0.005% of LOAD/°F [0.01% of LOAD/°C]
- COMPENSATED TEMP.** 60 to 160°F [15 to 72°C]
- OPERATING TEMP.** -60 to 200°F [-50 to 93°C]
- WEIGHT** 1 oz [28 g]
- MATERIAL** ALUMINUM
- DEFLECTION** 0.007 to 0.018 [0.18 to 0.46] nom.
- CABLE:** #29 AWG, 4 Conductor, Spiral Shielded Teflon Cable 10 ft [3 m] Long
- ACCESORIES AND RELATED INSTRUMENTS AVAILABLE**
- CALIBRATION (STD)** 5 pt. COMPRESSION; 60K Ω SHUNT CAL. VALUE
- CALIBRATION TEST EXCITATION** 5 VDC (0.25 to 5 lb) 10 VDC (10 lb)

CAPACITIES		
STK #	lb	N
FSH00934	0.25	1.1
FSH00935	0.5	2.2
FSH00936	1	4.5
FSH00937	1.5	6.7
FSH00938	2	8.9
FSH00939	5	22.2
FSH00940	10	44.5